

REVISIONS			
REV. NO.	DESCRIPTION	DATE	BY
1	change 4204 to 4206	MAY 08, 2008	BAP

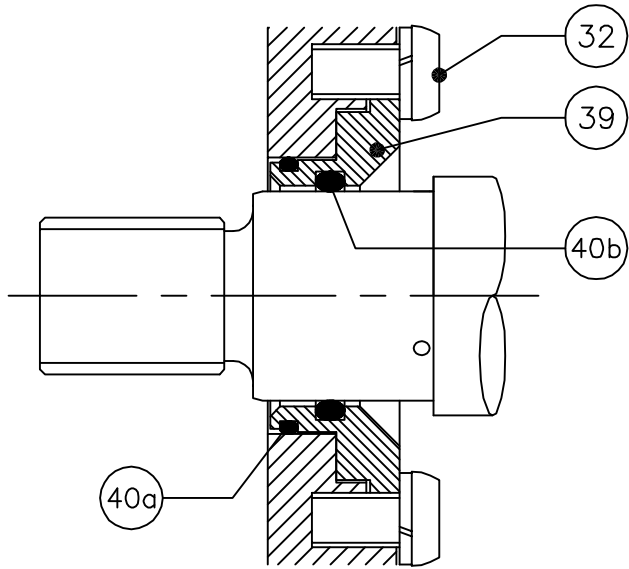

SINGLE O-RING SEAL

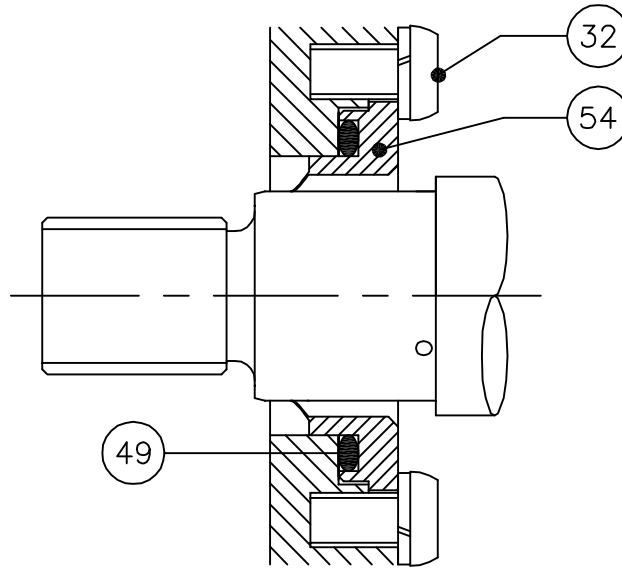

SINGLE O-LIP SEAL

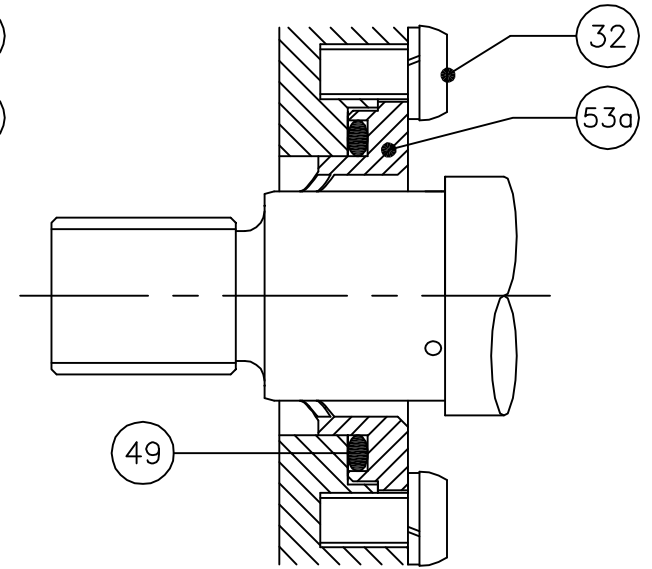

DOUBLE O-LIP SEAL

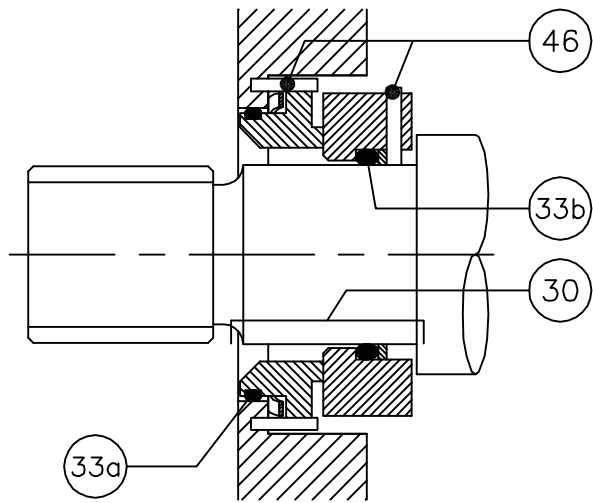

SINGLE MECHANICAL SEAL

54	1	5106	SINGLE LIP SEAL CARTRIDGE
53a	1	5107	DOUBLE LIP SEAL CARTRIDGE
49	1	4216	O-RING
46	5	4601-2	DOWEL PIN SET
40	1	4204, 4213	SINGLE O-RING SEAL O-RING SET (40a,40b)
39	1	4901-1L	RETAINING RING
33	1	4205, 4206	SINGLE MECH. SEAL O-RING SET (33a,33b)
32	2	4301-2	BOLT
30	1	CALL FACTORY	SINGLE MECHANICAL SHAFT SEAL
NO.	PCS. PER SEAL	PART NO.	DESCRIPTION

THIS DRAWING AND ALL IDEAS INCORPORATED IN ITS DESIGN IS THE EXCLUSIVE PROPERTY OF FLOWTECH, Inc. ITS ACCEPTANCE CONSTITUTES AN AGREEMENT THAT IT SHALL BE TREATED AS A CONFIDENTIAL DOCUMENT USED FOR NO OTHER PURPOSE THAN TO AID IN ITS CONSTRUCTION, THAT IT IS TO BE RETURNED UPON REQUEST, AND THAT IT IS NOT TO BE DISCLOSED OR COPIED EXCEPT AS AUTHORIZED IN WRITING BY FLOWTECH, Inc.

**UNIBLOC®**  
FLOWTECH DIV.  
ATLANTA, GA USA (770) 218-8900

DRAWN		BY	DATE	DWG. TITLE <b>UNIBLOC-PD &amp; GP PUMP SHAFT SEAL PARTS LIST</b>
CHECKED		JPZ		
APP'D				SIZE
SCALE		NONE		<b>200-275</b>
				DWG. NO. <b>G806</b>
RELEASE DATE MAY 21, 2001   SHEET 1 OF 1				