

REVISIONS		
SYMBOL	DESCRIPTION	DATE

UNIBLOC-GP 275[®]

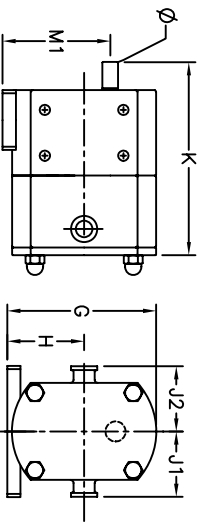

HORIZONTAL THROUGH-PUT

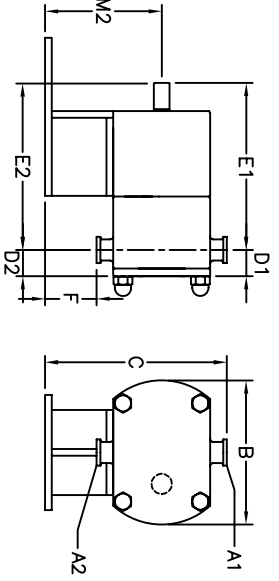

VERTICAL THROUGH-PUT

	GP275-07/07	GP275-10/07	GP275-10/10	GP275-15/15
A1	3/4"	1" TRI-CLAMP	1"	1.5"
A2	TRI-CLAMP	3/4" TRI-CLAMP	TRI-CLAMP	TRI-CLAMP
B		110 (4.33)		
C	155 (6.10)		167 (6.57)	
D1	16 (0.63)		26 (1.02)	
D2	16 (0.63)	20 (0.79)		26 (1.02)
E1	131 (5.16)		121 (4.76)	
E2	131 (5.16)	127 (5)		121 (4.76)
F		49 (1.93)		37 (1.47)
G			117 (4.61)	
H			62 (2.44)	
J1	53 (2.09)		65 (2.56)	
J2		53 (2.09)		65 (2.56)
K			147 (5.79)	
M1			82 (3.23)	
M2			102 (4.02)	
Ø			12 (0.47)	
WEIGHT ¹			6 (1.3)	
WEIGHT ²			4.1 (9)	

UNIBLOC-GP[®] 300-375

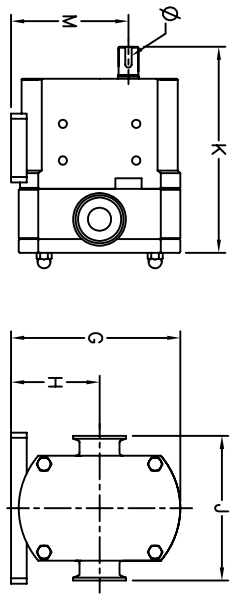

HORIZONTAL THROUGH-PUT

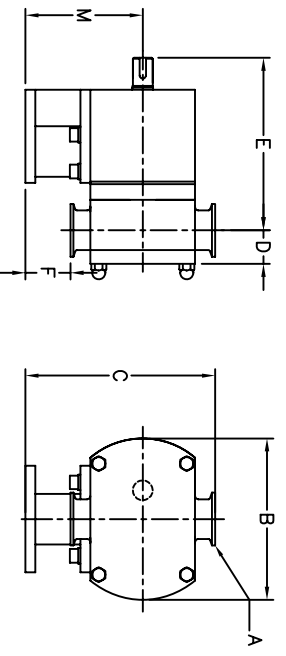

VERTICAL THROUGH-PUT

	GP300	GP350	GP375
A	1" TRI-CLAMP	1.5" TRI-CLAMP	2" TRI-CLAMP
B		154 (6.06)	
C		181 (7.13)	
D	32 (1.26)	39 (1.54)	46 (1.81)
E	165 (6.50)	170 (6.69)	175 (6.89)
F		43 (1.69)	
G		159 (6.26)	
H		84 (3.32)	
J		138 (5.43)	
K	197 (7.76)	209 (8.23)	221 (8.70)
M		43 (1.69)	
Ø		19 (0.75)	
WEIGHT ¹		20 (44)	23 (51)
WEIGHT ²		14 (32)	15 (33)

* 1 PUMP WITH STAINLESS STEEL GEARBOX. 2 PUMP WITH ALUMINUM GEARBOX



UNLESS OTHERWISE NOTED:		TOLERANCES		THIS DRAWING AND ALL SPECIFICATIONS ARE THE PROPERTY OF FLOWTECH PUMP, INC. AND ARE NOT TO BE REPRODUCED OR TRANSMITTED IN ANY FORM OR BY ANY MEANS, ELECTRONIC OR MECHANICAL, INCLUDING PHOTOCOPYING, RECORDING, OR BY ANY INFORMATION STORAGE AND RETRIEVAL SYSTEM, WITHOUT PERMISSION IN WRITING BY FLOWTECH PUMP, INC./FLOWTECH DIV.	
DECIMALS	± 0.1	ANGULAR	± 0.1°		
0.0	± 0.05	0.0°	± 0.05°		
0.00	± 0.005	0.00°	± 0.005°		
MATERIAL					
FINISH (UNLESS NOTED ON DWG.)		DRAWN	BY	DATE	
CHECKED		PO		12/08/09	
APPR'D					
SCALE					
ALL DIMENSIONS IN MM					
DWG. TITLE		SIZE		DWG. NO.	
GEARPUMP GENERAL DIMENSIONS		GP275-375		GP100	
RELEASE DATE DEC. 09, 2008		SHEET		1 OF 1	

ALL DIMENSIONS IN MM, INCHES IN (). T/C SHOWN.