

| REVISIONS |             | DATE | BY |
|-----------|-------------|------|----|
| SYMBOL    | DESCRIPTION |      |    |

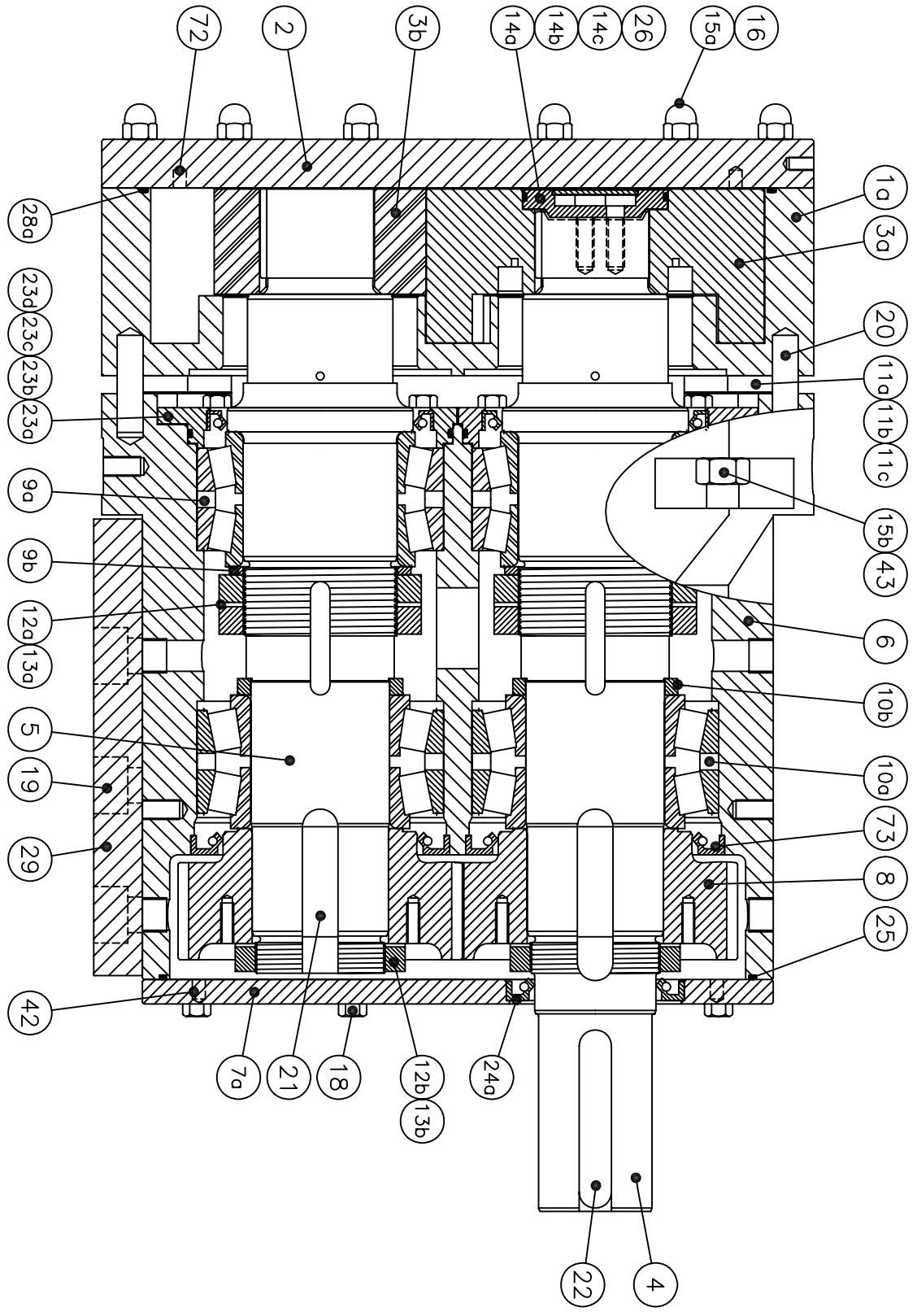

THIS DRAWING AND ALL RIGHTS HEREIN ARE THE PROPERTY OF FLOWTECH, INC. NO PART OF THIS DRAWING IS TO BE REPRODUCED OR TRANSMITTED IN ANY FORM OR BY ANY MEANS, ELECTRONIC OR MECHANICAL, INCLUDING PHOTOCOPYING, RECORDING, OR BY ANY INFORMATION STORAGE AND RETRIEVAL SYSTEM, WITHOUT THE WRITTEN PERMISSION OF FLOWTECH, INC.

|                               |                      |       |
|-------------------------------|----------------------|-------|
| MATERIAL                      | BY                   | DATE  |
| FINISH (UNLESS NOTED ON DWG.) | JPZ                  |       |
| WEIGHT                        | CHECKED              | APPD. |
|                               | SCALE                | NONE  |
|                               | ALL DIMENSIONS IN MM |       |

|                                       |               |                               |        |
|---------------------------------------|---------------|-------------------------------|--------|
| UNIBLOC®-PD                           |               | FLOWTECH DIV. ATLANTA, GA USA |        |
| DWG. TITLE UNIBLOC-PD PUMP PARTS LIST |               |                               |        |
| SIZE                                  | 600-675       | DWG. NO.                      | G818   |
| RELEASE DATE                          | JAN. 13, 2002 | SHEET                         | 1 OF 2 |

REGISTERED DESIGN: PATENTS PENDING

| ITEM NO. | PCS. PER PUMP | DESCRIPTION                                 | PART NUMBER  | SUB P.N. | SPECS.                       | MATERIAL       |
|----------|---------------|---|--------------|----------|------------------------------|----------------|
| 73       | 2             | OIL SEAL (GEAR CHAMBER)                     | 4146         | N        | 120x160x12                   | NITRILE        |
| 72       | 2             | DOWEL (ROTOR HOUSING COVER)                 | 4605         |          | M8x22, m6 DIN 6325           | HARD. STEEL    |
| 43       | 4             | NUTS (FOR STUDS)                            | 4441         | 2        | M20 (HEX NUT)                | SS             |
| 42       | 2             | DOWEL (BEARING HOUSING COVER)               | 4605         |          | M8x22, m6 DIN 6325           | HARD. STEEL    |
| 29       | 1             | GEARBOX FOOT                                | 3820         |          |                              |                |
| ② 28a    | 1             | O-RING (FRONT COVER-PRIMARY)                | 4240A        |          | 318x4 mm                     |                |
| 26       | 2             | O-RING (ROTOR BOLT)                         | 4245         |          | 3.234"x0.139 #236            |                |
| 25       | 1             | O-RING (BEARING HOUSING COVER)              | 4241         |          | 304x4mm                      |                |
| ① 24a    | 1             | OIL SEAL (BEAR. COVER)                      | 4140         |          | 75x110x12, AS                |                |
| 23d      | 12            | BOLT (HEX HEAD-FRONT BEARING RETAINER RING) | M10x30DIN933 |          | M10x30 (HEX)                 | SS             |
| 23c      | 2             | FRONT BEARING RETAINER RING                 | 3772         |          |                              |                |
| 23b      | 2             | O-RING (FRONT BEARING RETAINER RING)        | 4220         |          | 6.234"x0.139 #259            |                |
| 23a      | 2             | OIL SEAL (BEAR. HOUS.)                      | 4145         |          | 115x140x12                   |                |
| ③ 22     | 1             | KEY DIN 6885A                               | 4721         |          | 20x12x110 ROUNDED            | Plain Steel    |
| 21       | 2             | KEY DIN 6880                                | 4720         |          | 22x14x68 SQUARE              | Plain Steel    |
| 20       | 2             | DOWEL (BEARING HOUSING)                     | M16x60BN867  |          | M16x60, m6 DIN 6325          | HARD. STEEL    |
| 19       | 6             | GEARBOX FOOT BOLTS (SOCKET)                 | 4358         | 2        | M20x40 SOCKET                | 304SS          |
| 18       | 8             | GEARBOX COVER BOLTS (HEX HEAD)              | 4349         | 2        | M10x35 (HEX)                 | 304SS          |
| 16       | 12            | NUTS (FOR STUDS)                            | 4430         | 2        | M12 DOME, DIN1587/A2, BN 635 | SS             |
| 15c      | 4             | PORT FLANGE STUD                            | 3292         | 1        | BN 666 (M16x40)              | 316SS          |
| ② 15b    | 4             | BEARING HOUSING STUD                        | 3291         | 1        | M20x90                       | 316SS          |
| 15a      | 12            | FRONT COVER STUD                            | 3290         | 1        | BN 666 (12x40)               | 316SS          |
| 14c      | 2             | ROTOR BOLT WASHER CAP                       | 3391         | T        |                              | PTFE           |
| 14b      | 2             | ROTOR BOLT WASHER                           | 3390         | T        |                              | 316 L          |
| ② 14a    | 6             | ROTOR BOLTS (SOCKET HEAD)                   | 3392A        | 20       | M12x35 (SOCKET)              | TITANIUM GR. 5 |
| 13b      | 2             | NUTS (SLOTTED)                              | 4443         | 4        | M80x2P (KM16)                | EN8            |
| 13a      | 4             | NUTS (SLOTTED)                              | 4442         | 4        | M95x2P (KM19)                | EN8            |
| 12b      | 2             | TABWASHER                                   | 4521         | 4        | M80 (MB16)                   | EN8            |
| 12a      | 2             | TABWASHER                                   | 4520         | 4        | M85 (MB19)                   | EN8            |
| 11c      | 8             | BOLT (FLAT HEAD SOCKET-SHIM PLATE)          | M6x25BN616   | 2        | M6x25, DIN 7991 A2           | SS             |
| 11b      | 4             | SHIM  | 3676         |          |                              | BRASS          |
| 11a      | 4             | SHIM PLATE                                  | 3675         |          |                              | 303SS          |
| 10b      | 2             | REAR BEARING SHOULDER RING                  | 3796         | 4        |                              | EN8            |
| 10a      | 2             | REAR BEARING                                | 3795         |          | TIMK 596A/592D/XIS-594       |                |
| 9b       | 2             | FRONT BEARING SHOULDER RING                 | 3771         | 4        |                              | EN8            |
| 9a       | 2             | FRONT BEARING                               | 3770         |          | TIMK 594A/592D/XS-594        |                |
| 8        | 2             | GEARS                                       | 3620         |          | PAIR                         | EN36           |
| 7a       | 1             | BEARING HOUSING COVER                       | 3590         |          | PLAIN                        |                |
| 6        | 1             | BEARING HOUSING                             | 3540         |          | HORIZ/VERT MT.               |                |
| 5        | 1             | LAY SHAFT                                   |              | 1L       | ROTOR LOCK                   | 316 L          |
| 4        | 1             | DRIVE SHAFT                                 |              | 1L       | ROTOR LOCK                   | 316 L          |
| ③ 3b     | 2             | PLASTIC ROTOR                               |              | 12       | PET                          | 316SS          |
| ③ 3a     | 2             | METAL ROTOR                                 |              | 1        |                              | 316SS          |
| 2        | 1             | ROTOR COVER                                 | 3240         | 1L       | PLAIN                        | 316 L          |
| 1c       | 2             | O-RING (PORT FLANGE-PRIMARY)                |              |          |                              | 316SS          |
| 1b       | 2             | PORT FLANGE                                 |              | 1        |                              | 316SS          |
| 1a       | 1             | ROTOR HOUSING                               |              | 1        |                              | 316SS          |

THIS DRAWING AND ALL DATA INCORPORATED IN THE DESIGN IS THE EXCLUSIVE PROPERTY OF FLOWTECH, INC. ITS SCOPE AND CONTENTS ARE LIMITED TO THE DOCUMENT USED FOR NO OTHER PURPOSE. THIS DOCUMENT IS NOT TO BE REPRODUCED OR COPIED EXCEPT AS AUTHORIZED BY FLOWTECH, INC. IN WRITING BY FLOWTECH, INC./FLOWTECH DIV.



TEKNOFLOW, INC. ATLANTA, GEORGIA-USA  
 DWG. TITLE UNIBLOC-PD PUMP PARTS LIST

|                      |     |      |              |              |              |
|----------------------|-----|------|--------------|--------------|--------------|
| DRAWN                | BY  | DATE | SIZE         | DWG. NO.     | REV. NO.     |
| CHECKED              | JPZ |      | 600-675      | G818         | 4            |
| APP'D.               |     |      | SCALE        |              |              |
|                      |     |      | NONE         |              |              |
| ALL DIMENSIONS IN MM |     |      | RELEASE DATE | NOV. 9, 2002 | SHEET 2 OF 2 |