

SIGHTGLASS

MODEL #53



FLOWTECH DIV.

Teknoflow Inc. Atlanta, GA USA

APPLICATIONS

Improved engineering on Flowtech's #52 Bulls-Eye Sightglass and the #53 In-Line Sightglass allows them to meet the most demanding requirements for quality and superior performance for both high and low pressure applications. Both style of sightglasses are suitable for beverage, pharmaceutical / bio-tech and related industries.

DESIGN

The #52 Bulls-Eye Sightglass is fitted with two rigid glass view-ports on opposite sides. Inside the retainers are gaskets. The glass disks are located and kept in place by a fine threaded ring.

The #53 In-Line Sightglass design consists of a glass tube compressed between flanges. Flowtech's double nut tensioning arrangement prevents over-tightening of the glass. As a safety precaution an electropolished stainless steel grid surrounds the glass tube. Standard connections are sanitary Tri-Clamp. Other connection options are also available. Our new #53 style features two flanges threaded to a center piece which acts as a guard to the glass.

MATERIALS

All wetted surfaces are **304 or 316L stainless steel**.
Wetted "glass" material is Pyrex.
O-ring elastomers available in EPDM, Silicone or Viton.

OPTIONAL

- **316L** cone shaped strainer cartridge available in multiple mesh sizes for #53 In-Line Sightglass on sizes 3" and up.
- Polish up to 15 Ra (0.4 micron, μm) and / or **electropolishing**
- **Hastelloy-C** and **AL6XN** material
- Elastomers of **USP Class VI** material
- Borosilicate glass available for temperatures 250°F up to 550°F
- Acrylic glass available
- Optional drain available for #53 In-Line Sightglass
- Material test report available

	#52	#53
Maximum temperature	250°F	250°F
Minimum temperature	-20°F	-20°F
Max prod. pressure (0.5-0.75")	n/a	200 psig
Max prod. pressure (1.0-1.5")	400 psig	150 psig
Max prod. pressure (2.0-2.5")	200 psig	150 psig
Max prod. pressure (3.0")	200 psig	125 psig
Max prod. pressure (4.0")	120 psig	95 psig
Max prod. pressure (6.0")	POA	95 psig
Optional drain connection	-	1" clamp

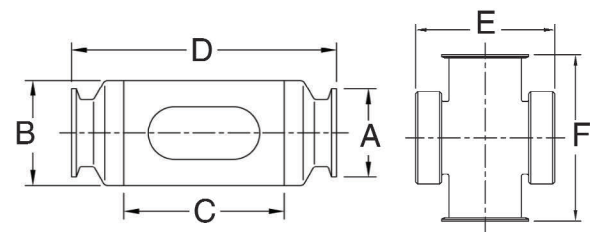
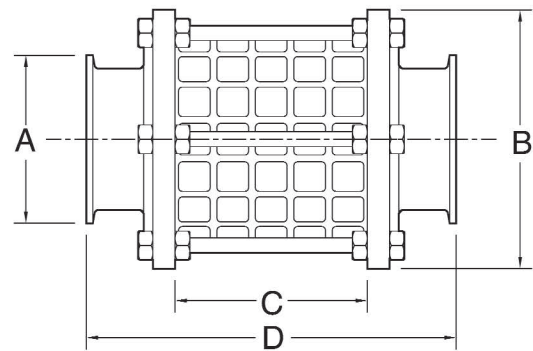

Size	B		C		D		E		F	
A	mm	in	mm	in	mm	in	mm	in	mm	in
0.5"	27	1.1	78	3.1	135	5.3	-	-	-	-
0.75"	34	1.3	78	3.1	135	5.3	-	-	-	-
1.0"	42	1.7	81	3.2	152	6.0	117	4.6	145	5.7
1.5"	60	2.4	81	3.2	152	6.0	117	4.6	145	5.7
2.0"	70	2.8	81	3.2	152	6.0	132	5.2	178	7.0
2.5"	127	5.0	99	3.9	175	6.9	147	5.8	178	7.0
3.0"	142	5.6	99	3.9	201	7.9	162	6.4	190	7.5
4.0"	162	6.4	99	3.9	204	8.0	193	7.6	228	9.0
6.0"	226	8.9	162	6.4	305	12.0	POA	POA	POA	POA

* 1cps (water at ambient temp)
Technical changes without notice



Distributor:

FLOWTECH DIV.

Teknoflow Inc. Atlanta, GA USA

1701 Spinks Drive, Marietta, Georgia 30067-8925
Telephone: (770) 218-8900 Fax: (770) 218-8442
www.flowtechdiv.com info@flowtechdiv.com